

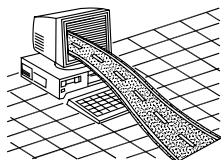

autostrade // per l'italia
Società per azioni

**BARRIERA "AUTOSTRADA" DA SPARTITRAFFICO
NEW JERSEY MONOFILARE SIMMETRICO
IN CALCESTRUZZO ALLEGGERITO - $H = 120$
CLASSE H4**

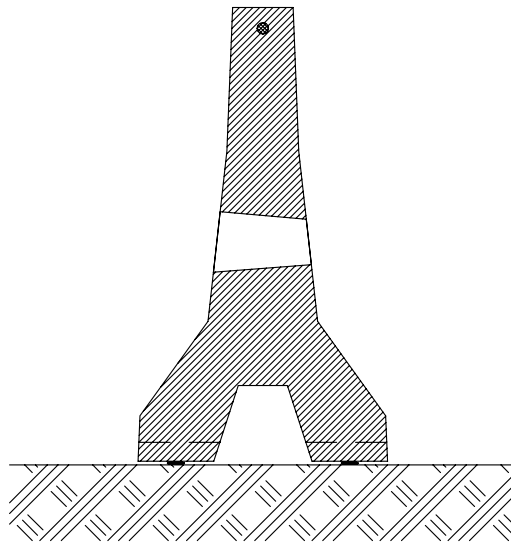

**Direzione Sourcing e Tecnica Esercizio
Manutenzione e Standard di Pavimentazioni e Barriere
Opere di Sicurezza**

7 Aprile 1999

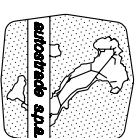
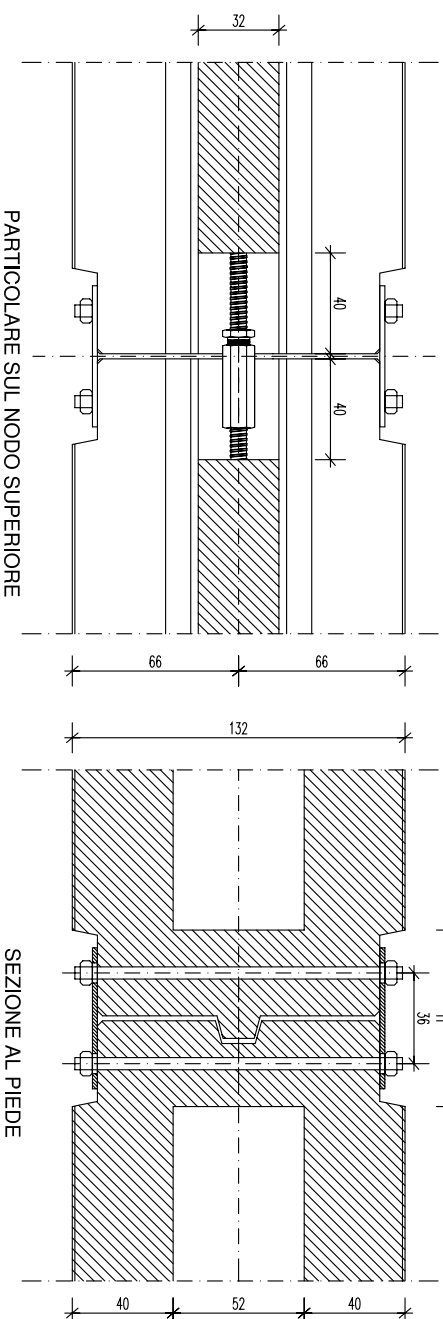
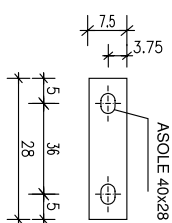
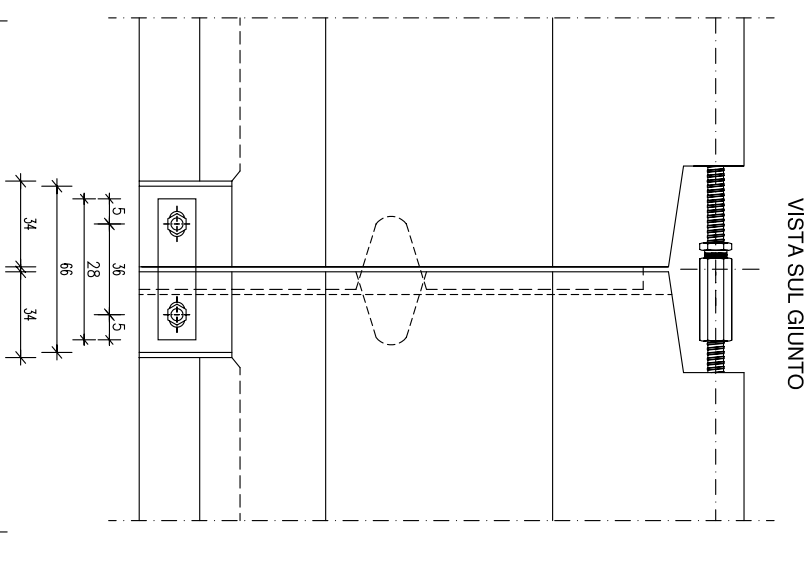
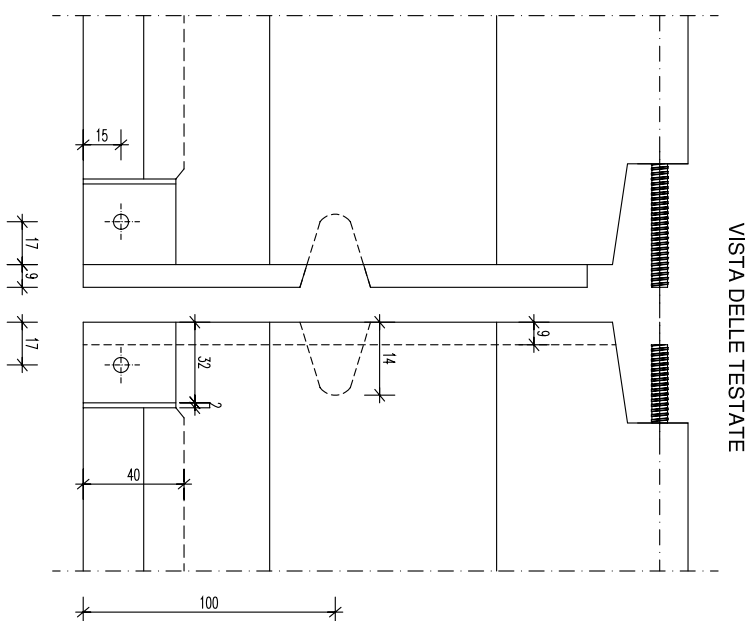
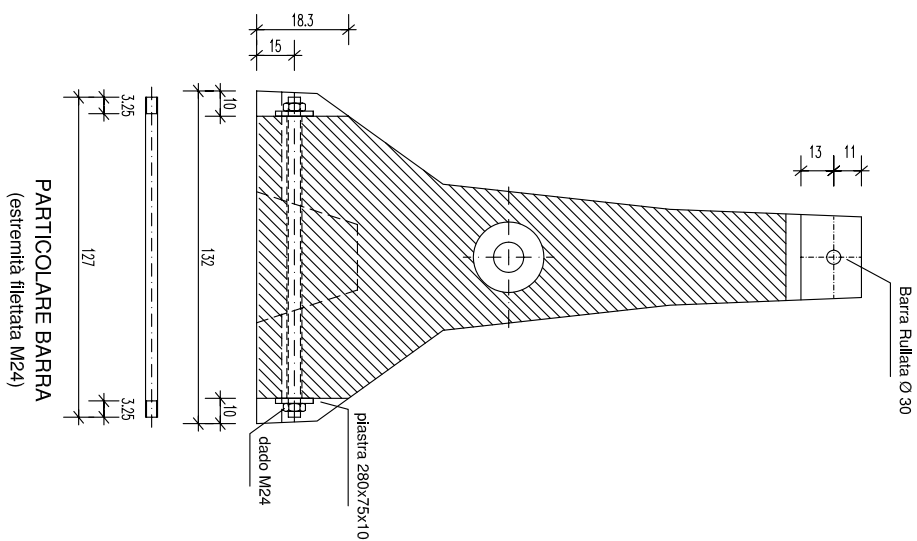
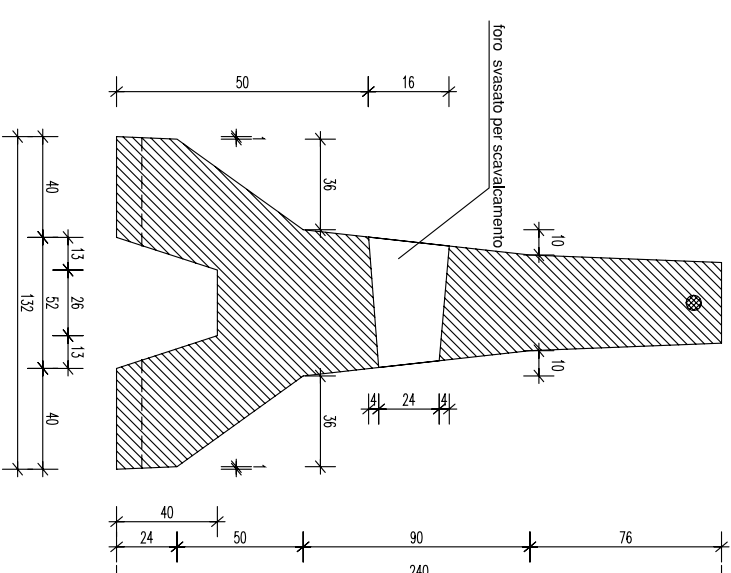
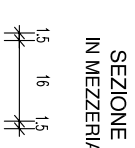
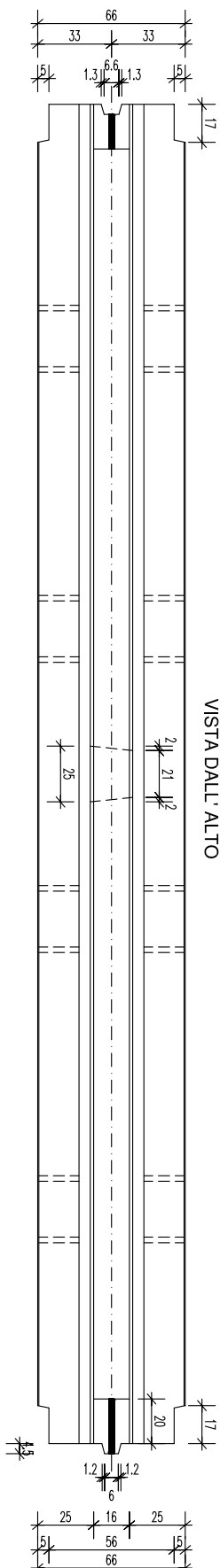
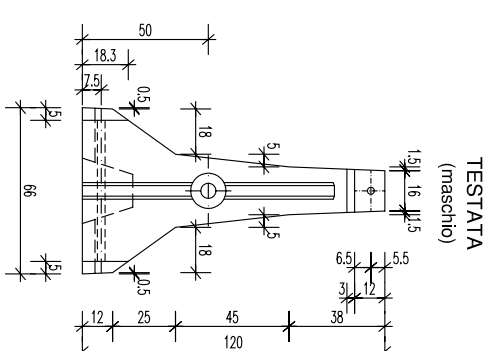
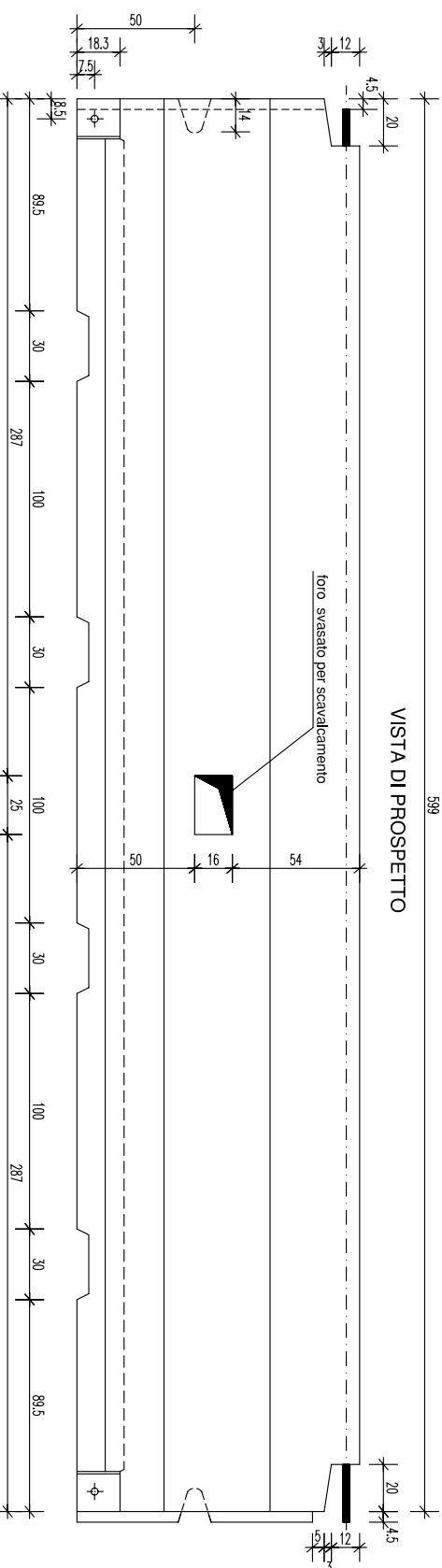
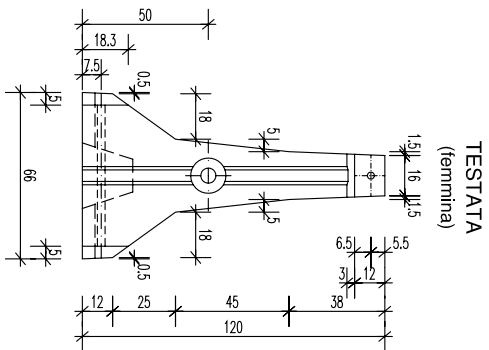

ROMA - Via A. Bergamini 50

Autostrade S.p.A. - Gruppo IRI
BARRIERA NEW JERSEY MONOFILARE
CLASSE H4
(Brevetto AUTOSTRADE)
CARPENTERIA

<i>dis. n.</i>	CRS 5A
<i>scada</i>	1:10 1:5
<i>dis. da</i>	CRS/RSL/S
<i>data</i>	7.4.1999
<i>oggiorn.</i>	
<i>file</i>	MONOFI4

VISTA LATERALE ARMATURA

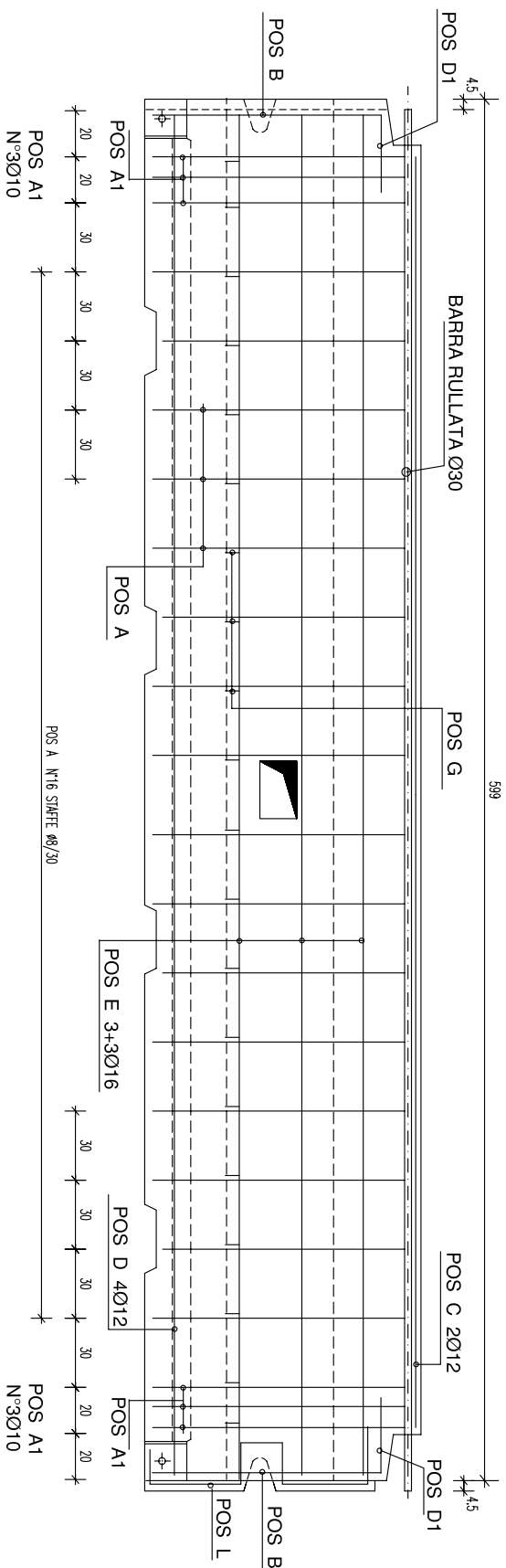

VISTA LATERALE ARMATURA ALL'ESTREMITA'

ARMATURA
ALL'ESTREMITA'

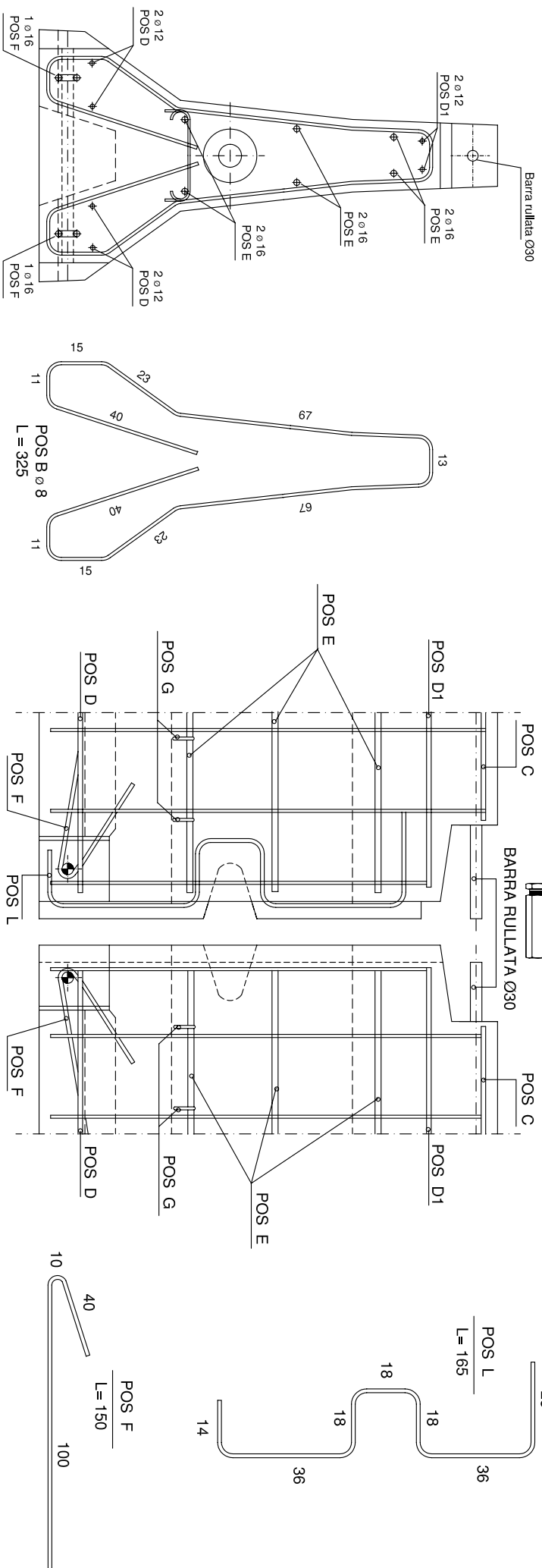

ARMATURA
IN MEZZERIA

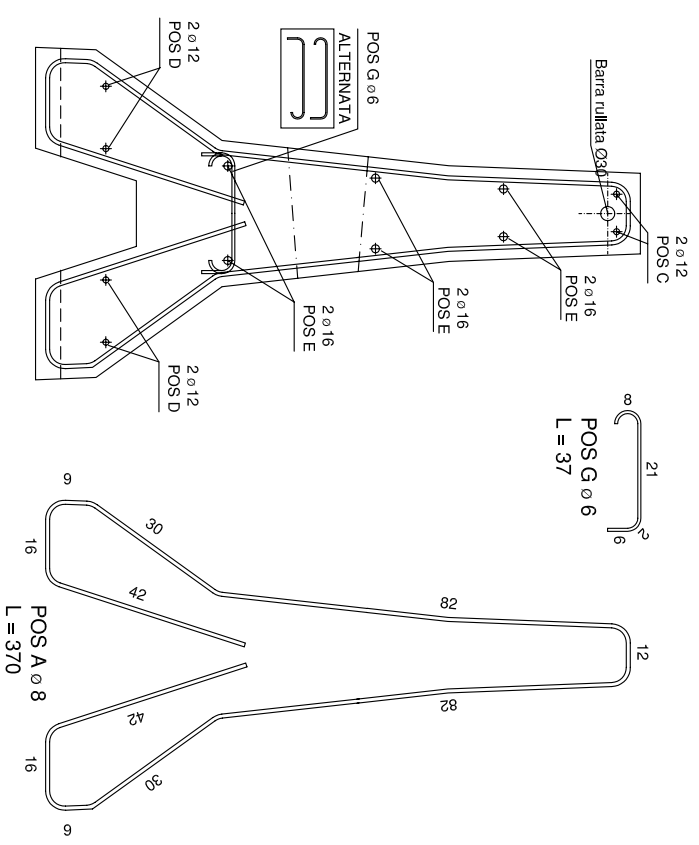

MATERIALI

CALCESTRUZZO ALLEGGERITO : $R_{ck} > 400 \text{ daN/cm}^2$

(Peso Specifico 1820-1880 Kg/mc)

ARMATURA Acciaio Fe B44K

GIUNTI Barre Fe B32K

POS.	N°	L _r unt.	L _r tot.	Ø	Tot. Kg.
A	16	3.70	59.20	8	23.38
A1	6	3.70	22.20	10	13.70
B	2	3.25	6.50	8	2.57
C	2	5.50	11.00	12	9.77
D	4	5.93	23.72	12	21.06
D1	2	1.00	2.00	12	1.78
E	6	5.93	35.58	16	56.14
F	4	1.50	6.00	16	9.46
G	20	0.37	7.40	6	1.64
L	1	1.65	1.65	10	1.02
BARRA PULLATA Ø30 Acciaio 39NiCrMo3 Bonificato L= 5.99					33.24
					173.76

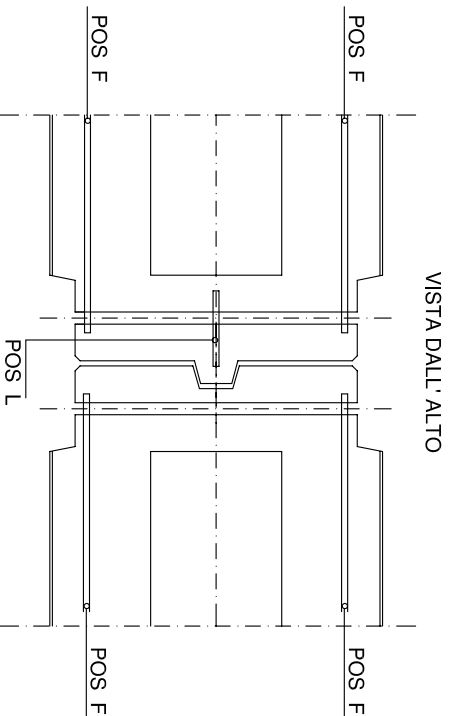
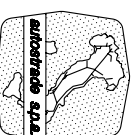
**autostrade**

ROMA - Via A. Bergamini 50

Autostrade S.p.A. - Gruppo IRI

BARRIERA NEW JERSEY MONOFILARE

CLASSE H4

(Brevetto AUTOSTRADE)

ARMATURA

<i>dis. n.</i>	CRS 5B
<i>scda</i>	1:10 1:5
<i>dis. da</i>	CRS/RSI/SE
<i>data</i>	7.4.1999
<i>oggiom.</i>	
<i>file</i>	MONOFI4

VISTA DI LATO

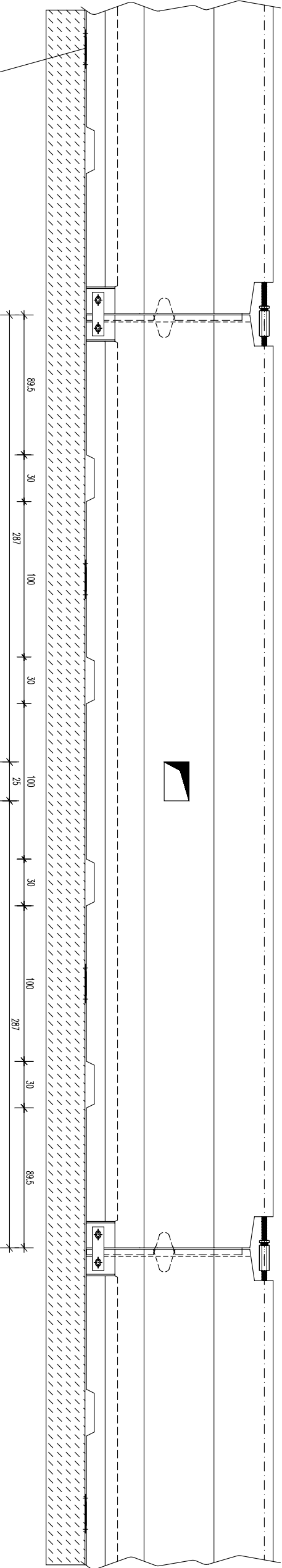

VISTA DALL' ALTO

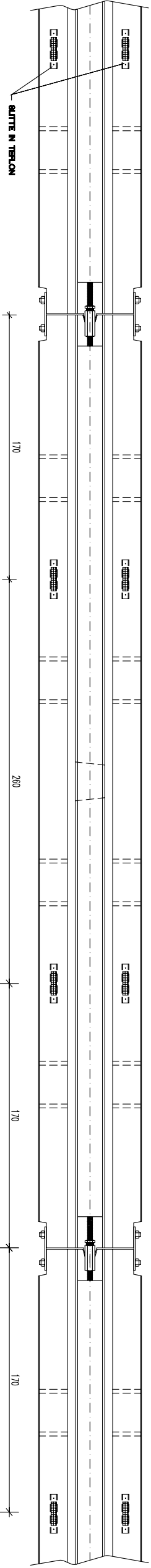

SLITTE IN TEFLON

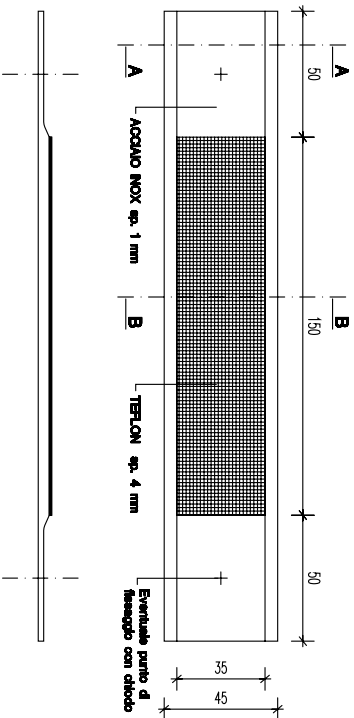

Sezione A-A

Sezione B-B

Sezione C-C

- LE SLITTE IN TEFLON SONO FISSATE AL SUPPORTO CON DUE CHIODI O TRAMITE DONEO COLLANTE
- OGNI ELEMENTO DI BARRIERA POGGIA SU 4 SLITTE IN TEFLON
- PER COMPENSARE EVENTUALI IRRREGOLARITA' DEL SUPPORTO POTRANNO ESSERE MESSE, SOPRA LE SLITTE, DELLE PIASTRINE DI ACCIAIO DI DONEO SPESORE

MANICOTTO PER BARRE IN ACCIAIO PR80 365MMPX10

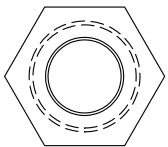
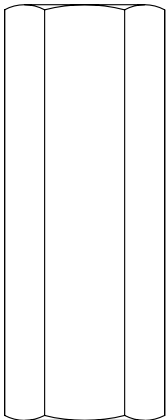
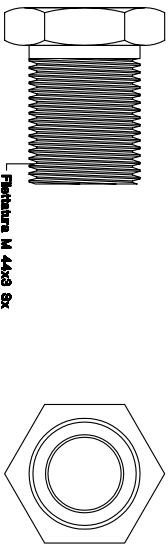

55

55

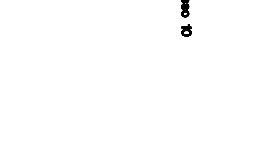
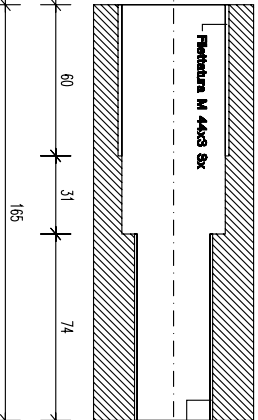
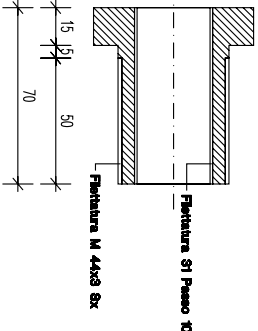

autostrade

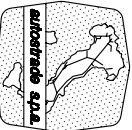

ROMA - Via A. Bergamini 50

Autostrade S.p.A. - Gruppo IRI

BARRIERA NEW JERSEY MONOFILARE
CLASSE H4
(Brevetto AUTOSTRAD)

A C C E S S O R I

dis. n.	CRS 5C
scala	Varie
dis. da	CRS/RSI/SB
data	7.4.1999
aggiorn.	
file	MONOFI4